

# A NEW RECYCLING BUILDING FOR LONDON, OHIO

A NEW RECYCLING BUILDING FOR  
LONDON, OHIO  
NORTH CENTRAL OHIO SOLID WASTE DISTRICT  
233 JENKINSON DRIVE  
LONDON, OHIO 43140  
MADISON COUNTY

## GENERAL NOTES FOR CONSTRUCTION

- ALL DIMENSIONS SHALL BE VERIFIED AT THE JOB BY THE GENERAL CONTRACTOR AND DESCRIBED TO THE ENGINEER. THE ENGINEER MUST BE NOTIFIED IMMEDIATELY IN WRITING OF ANY DISCREPANCIES IN THE FIELD CONDITION WHICH IS NOT ACCORDING TO THE DRAWINGS. PRIOR TO ANY PROCEEDING WITH THE WORK, THE ENGINEER MUST BE NOTIFIED OF ANY FIELD CHANGES WHICH AFFECT MEANS OR METHODS OF CONSTRUCTION. ALL PERMITS SHALL BE OBTAINED FROM THE APPROPRIATE AGENCIES. ALL PERMIT WORK SHALL CONFORM TO ALL APPLICABLE ELECTRICAL AND MECHANICAL BUILDING CODES. FINAL APPROVAL AT THE SITE WITH THE GOVERNING AGENCY'S INSPECTOR IS MANDATORY.
- IT SHALL BE THE RESPONSIBILITY OF THE GENERAL CONTRACTOR TO VERIFY THESE ASSUMPTIONS, AND ALSO TO MAKE NECESSARY REVISIONS TO THE BUILDING STRUCTURE AND THE PARKING LOT DESIGN. ALL REVISIONS SHALL BE SUBMITTED TO THE ENGINEER FOR REVIEW AND APPROVAL BY THE GENERAL CONTRACTOR'S LOCAL CIVIL/STRUCTURAL ENGINEERING FIRM TO INCLUDE FINAL SITE AND GRADING PLAN DOCUMENTS.
- ANY PRE-ENGINEERED WOOD TRUSSES OR PRE-ENGINEERED WOOD BEAMS SHALL BE DESIGNED AND BECOME THE RESPONSIBILITY OF THE MANUFACTURER OF THE PRE-ENGINEERED SYSTEM AND SHALL BE DESIGNED BY A LICENSED PROFESSIONAL ENGINEER BEARING HIS/HER STAMP.
- THE CONTRACTOR SHALL COORDINATE AND BE RESPONSIBLE FOR SEQUENCING OF THE CONSTRUCTION. THE STRUCTURE IS DESIGNED TO BE SELF-SUPPORTING AND STABLE AFTER THE BUILDING IS FULLY COMPLETED. THE CONTRACTOR SHALL VERIFY THE FOUNDATION DESIGN AND CONSTRUCTION PROCEDURE AND SEQUENCE AND TO INSURE THE SAFETY OF THE BUILDING AND ITS COMPONENT PARTS DURING ERECTION. THIS INCLUDES THE ADDITION OF WHATEVER SHORING, SHEETING, TEMPORARY BRACING GUTS OR TIE-DOWNS WHICH MIGHT BE NECESSARY.
- IT IS THE CONTRACTOR'S SOLE RESPONSIBILITY TO FOLLOW ALL APPLICABLE SAFETY & BUILDING CODES AND REGULATIONS DURING ALL PHASES OF CONSTRUCTION.
- THESE CONTRACT DOCUMENTS ARE DESIGNED TO MEET THE REQUIREMENTS FOR THE STATE OF OHIO AND THE 2007 OBC.
- THE CONTRACTOR SHALL VISIT THE SITE PRIOR TO BIDDING TO INSPECT EXISTING FIELD CONDITIONS. THIS CONTRACT SHALL INCLUDE LABOR AND MATERIALS NECESSARY FOR FIELD MODIFICATIONS DUE TO EXISTING CONDITIONS. ANY CONTRACTOR PROPOSED CHANGES OR DEVIATIONS TO THE DESIGN AS SHOWN SHALL BE SUBMITTED TO CONCEPT BUILDINGS.
- THIS STRUCTURE IS NOT LOCATED IN A FLOOD HAZARD AREA.

## STRUCTURAL/BUILDING LOADS

ROOF LIVE LOAD (PSF): 20 PSF  
REDUCIBLE PER CODE  
MBMA OCC. CLASS: II  
GROUND SNOW LOAD: 20 PSF  
SNOW EXP. FACTOR,  $C_e$ : 1  
WIND IMPORTANCE FACTOR  $I_s$ : 1  
WIND LOAD: 90 MPH  
WIND IMPORTANCE FACTOR: 1.00  
MADISON CO. FROST DEPTH: 32"  
UL 90  YES  NO  
CLASSIC ROOF-CONST. NO. 161, CLASSIC ROOF W/ TRANSLUCENT PANEL-CONST. NO. 590, GFR ROOF-CONST. 591, GFR ROOF W/ TRANSLUCENT PANEL-CONST. NO. 590, VR16 ROOF-CONST. NO. 506  
SEISMIC INFORMATION  $S_s$ : 0.166  $S_1$ : 0.063  
 $S_{M1}$  (SDP)  $S_{M2}$  (SDP)  $S_{M3}$  (SDP)  
SEISMIC IMPORTANCE FACTOR: 1.00  
SITE CLASS: D  
SEISMIC DESIGN CATEGORY: B  
ANALYSIS PROCEDURE: EQUIVALENT LATERAL FORCE METHOD  
BASIS SFRS:  NOT RETAINED FOR SEISMIC  
 PRIMARY STEEL MOMENT RESISTING FRAMES AND ORDINARY  
 STEEL CONCENTRICALLY BRACED FRAMES.

## NOTES:

- COLLATERAL DEAD LOADS, UNLESS OTHERWISE NOTED, ARE ASSUMED TO BE UNIFORMLY DISTRIBUTED. WHEN SUSPENDED SPRINKLER SYSTEMS, LIGHTING, CEILING, MECHANICAL, ETC., ARE INSTALLED, THE CONTRACTOR SHALL CONSULT THE M.B.S. FOR THESE CONCENTRATED LOADS EXCEED 200 POUNDS, OR IF INDIVIDUAL MEMBERS ARE LOADED SIGNIFICANTLY MORE THAN OTHERS.
- THE DESIGN OF STRUCTURAL MEMBERS SUPPORTING GRAVITY LOADS IS CONTROLLED BY THE MORE CRITICAL EFFECT OF ROOF LIVE LOAD OR ROOF SNOW LOAD, AS DETERMINED BY THE APPLICABLE CODE.

BUILDING	
MAIN	
ROOF DEAD LOAD (PSF):	3
SEC. COOL. (PSF):	0
SNOW CH. (PSF):	1.2
ROOF SNOW CH.:	1.00
WIND ENCLASURE:	PARTIAL
GCP:	* 0.55
SEISMIC R.:	3
SEISMIC CH.:	0.059
BASE SHEAR (KIP):	1.17

- ONE OR MORE BUILDINGS INCLUDE NO PROVISIONS FOR COLLATERAL LOAD PER CUSTOMER REQUEST. COLLATERAL LOADS ARE NON-STRUCTURAL LOADS INCLUDING LIGHTING, CEILING, MECHANICAL, FIRE PROTECTION SYSTEMS, ETC. MBRS RESUMES NO RESPONSIBILITY FOR THE ADDITION OF COLLATERAL LOADS TO THESE BUILDINGS.

## GENERAL BUILDING NOTES

- GROUNDING OF METAL ON ALL BUILDINGS SHALL COMPLY WITH THE REQUIREMENTS OF CHAPTER 27 AND NFPA 70. SEE SECTION 1405.10.4 OF THE OBC.
- PORTABLE FIRE EXTINGUISHERS SHALL BE PROVIDED IN OCCUPANCIES AND LOCATIONS AS REQUIRED BY THE INTERNATIONAL FIRE CODE, OBC 906.1. THE FIRE EXTINGUISHERS SHALL BE 25 ABC'S LOCATED AT EACH EXTERIOR EXIT DOOR AND OTHER LOCATIONS PER LOCAL FIRE MARSHAL.
- PER OBC 1004.1.1 THRU 1004.1.3, REFLECTING THE TABULAR OCCUPANT LOAD FOR F-1. SEE OBC DATA THIS SHEET.
- SEE CHAPTER 19, SECTION 1905.9.1 FOR PROTECTION FROM FROST. BUILDINGS AND OTHER STRUCTURES SHALL BE PROTECTED FROM FROST BY ONE OR MORE OF THE FOLLOWING METHODS: E. EXTENDING BELOW THE FROST LINE OF THE LOCALITY.
- NO. HWS. SYSTEM IS REQUIRED AS THE BUILDING WILL NOT BE HEATED OR COOLED AND OCCUPIED LESS THAN 4 HOURS A DAY.
- THIS RECYCLING FACILITY IS USED AS A DROP OFF POINT FOR EMPTY PLASTIC BOTTLES AND OTHER RECYCLABLES. ALL SYSTEMS SHALL BE DESIGNED TO SEPARATE AND COMPACT EACH ITEM. NO HAZARDOUS OR EXPLOSIVE MATERIAL ARE HANDLED AT THIS SITE. SORTED ITEMS ARE THEN TRANSFERRED TO OTHER FACILITIES AT OTHER SITES FOR FURTHER PROCESSING.

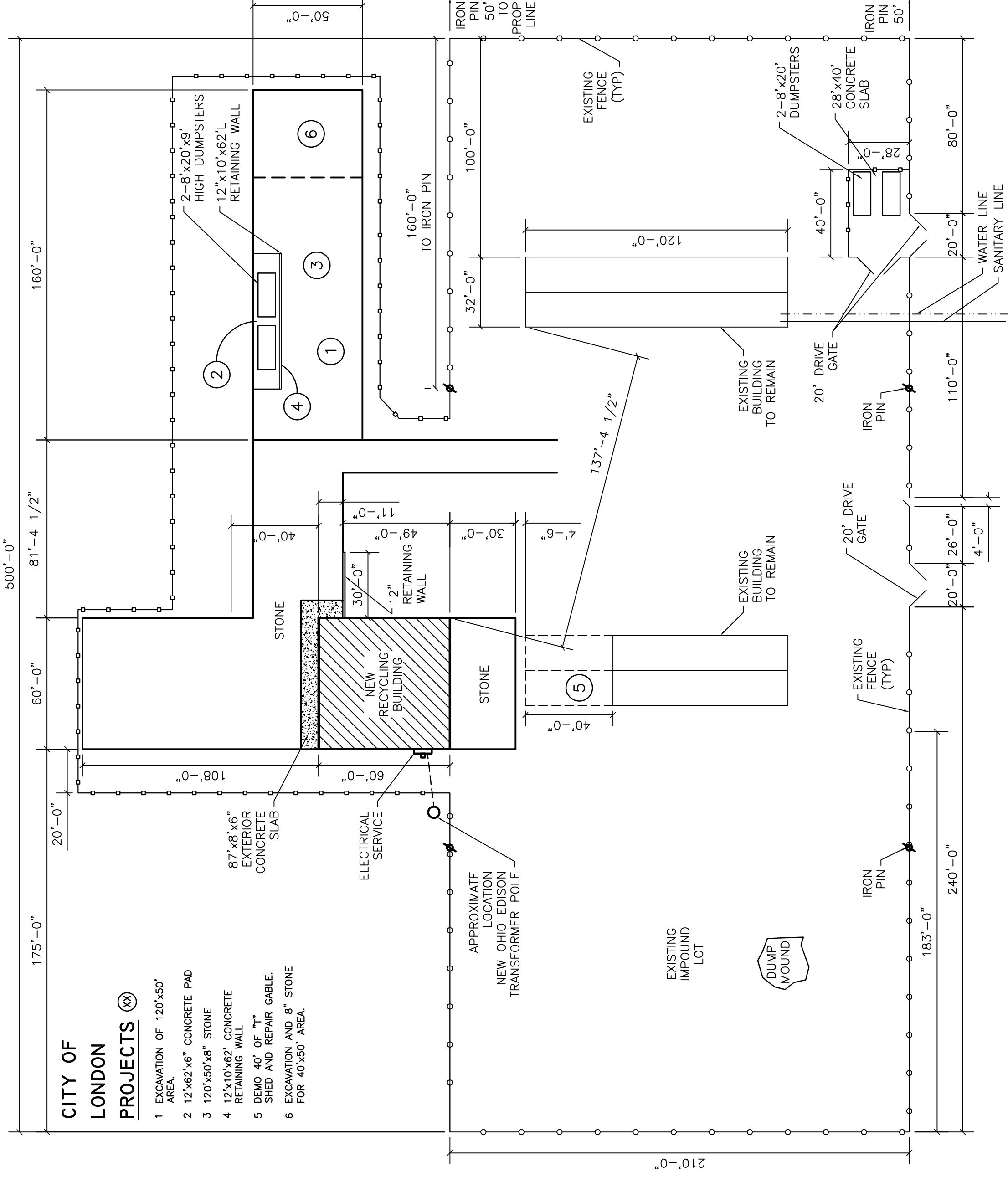

## SITE PLAN

SCALE: 1" = 40'



## INDEX OF SHEETS

C.1	COVER SHEET, DESIGN LOADS, SITE PLAN, GEN. INFO
A.1	EXTERIOR ELEVATIONS
A.2	FOUNDATION/BASEMENT PLAN, NOTES
A.3	ANCHOR BOLT LOCATIONS, NOTES
A.4	REACTIONS, RIGID FRAME, ENDWALL, BRACING

## OBC DATA

USE GROUP: "F-1"  
CONSTRUCTION TYPE: 3B  
TOTAL AREA: 3,589 SQ.FT.  
MAXIMUM EMPLOYEES: 7

NO.	CORR. LTR	DATE	REVISED	ISSUE DATE

DESIGN BY PROFESSIONAL:

**PIZZINO ENGINEERING & CONSULTING, LLC.**  
WILLIAM J. PIZZINO, P.E.  
9495 SR 161  
PLAIN CITY, OHIO 43064

**CONCEPT BUILDINGS, INC.**  
MARYSVILLE, OHIO  
(937) 644-0605

THIS SHEET:  
COVER SHEET  
DATA INFO, INDEX  
SITE PLAN

PROJECT:  
RECYCLING BLDG

DATE: 09-19-07

DRAWN BY: P.R.M.

SCALE: AS NOTED

SHEET

1 OF 9

**C.1**