

A NEW SALON/BARBER SHOP FOR

J. TRIM

GENERAL NOTES FOR CONSTRUCTION

- ALL DIMENSIONS SHALL BE VERIFIED AT THE JOB BY THE GENERAL CONTRACTOR AND EACH SUB-CONTRACTOR AND THE ENGINEER MUST BE NOTIFIED OF ANY DISCREPANCIES WITH DIMENSIONS OR ANY OTHER FIELD CONDITION WHICH IS NOT ACCORDING TO THE DRAWINGS, PRIOR TO PROCEEDING WITH THE WORK. THE ENGINEER MUST BE NOTIFIED OF ANY FIELD CHANGES WHICH AFFECT MEANS OF EGRESS OR ANY OTHER LIFE SAFETY ITEMS WHICH ARE GOVERNED BY OBOA AFTER THE BUILDING PERMIT HAS BEEN ISSUED BY THE GOVERNING PLAN EXAMINING AGENCY. ALL WORK SHALL CONFORM TO ALL APPLICABLE ELECTRICAL AND MECHANICAL BUILDING CODES. FINAL APPROVAL AT THE SITE WITH THE GOVERNING AGENCY'S INSPECTOR IS MANDATORY.
- IT SHALL BE THE RESPONSIBILITY OF THE GENERAL CONTRACTOR TO VERIFY THESE ASSUMPTIONS AND ALSO TO MAKE NECESSARY REVISIONS TO THE BUILDING STRUCTURE AND THE PARKING LOT DESIGN. ALL NECESSARY INFORMATION TO BE NOTED OR DOCUMENTS PROVIDED BY THE GENERAL CONTRACTOR'S LOCAL CIVIL/STRUCTURAL ENGINEERING FIRM TO INCLUDE FINAL SITE AND GRADING PLAN DOCUMENTS.
- ANY PRE-ENGINEERED WOOD TRUSSES OR PRE-ENGINEERED WOOD BEAMS SHALL BE DESIGNED AND BECOME THE RESPONSIBILITY OF THE MANUFACTURER OF THE PRE-ENGINEERED SYSTEM AND SHALL BE DESIGNED BY A LICENSED PROFESSIONAL ENGINEER BEARING HIS/HER STAMP.
- THE CONTRACTOR SHALL COORDINATE AND BE RESPONSIBLE FOR SEQUENCING OF THE CONSTRUCTION. THE STRUCTURE IS DESIGNED TO BE SELF-SUPPORTING AND STABLE AFTER THE BUILDING IS FULLY COMPLETED. IT IS THE CONTRACTOR'S SOLE RESPONSIBILITY TO DETERMINE ERECTION PROCEDURE AND SEQUENCE AND TO INSURE THE SAFETY OF THE BUILDING AND ITS COMPONENT PARTS DURING ERECTION. THIS INCLUDES THE ADDITION OF WHATEVER SHORING, SHEETING, TEMPORARY BRACING GUYS OR TIE-DOWNS WHICH MIGHT BE NECESSARY.
- IT IS THE CONTRACTOR'S SOLE RESPONSIBILITY TO FOLLOW ALL APPLICABLE SAFETY & BUILDING CODES AND REGULATIONS DURING ALL PHASES OF CONSTRUCTION.
- THESE CONTRACT DOCUMENTS ARE DESIGNED TO MEET THE REQUIREMENTS FOR THE STATE OF OHIO AND THE 2007 OBC.
- THE CONTRACTOR SHALL VISIT THE SITE PRIOR TO BIDDING TO INSPECT EXISTING FIELD CONDITIONS. THIS CONTRACT SHALL INCLUDE LABOR AND MATERIALS NECESSARY FOR FIELD MODIFICATIONS DUE TO EXISTING CONDITIONS. ANY CONTRACTOR PROPOSED CHANGES OR DEVIATIONS TO THE DESIGN AS SHOWN SHALL BE SUBMITTED TO CONCEPT BUILDINGS.
- NATURAL VENTILATION @4% OF FLOOR PLAN AREA. AREA = 690 SQFT. $690 \times 4\% = 27.6$ SQFT OF VENTILATION REQUIRED. THE FRONT DOOR IS $3' \times 6.67' = 20$ SQFT. THE FRONT WINDOW IS $5FT \times 4FT = 20$ SQFT / 5 IS 10 SQFT OPENABLE. THE WINDOW IN THE DISPENSARY/OFFICE AREA WHICH IS $30 \times 30 = 6.25 / 2 = 3.125$ SQFT VENTILATION. SO, $20 + 10 + 3.125 = 33.125$ SQFT AND MEETS THE 27.6 SQFT VENTILATION REQUIREMENT.

STRUCTURAL NOTES

- STRUCTURAL DESIGN LOADS:**
 - FLOOR LIVE LOAD: 50 psf
 - WIND LOAD: CORRESPONDING TO 90mph WIND SPEED.
 - ATTIC LIVE LOAD: 20psf
 - GROUND SNOW LOAD: 20psf
 - SOIL LOAD BEARING: ASSUMED 1500psf
- CONCRETE STRENGTH:**
 - MINIMUM CONCRETE REQUIREMENTS, SEE TABLE 1904.2.1, PER OBC.
 - FOOTINGS AND FOUNDATION WALLS: SHALL BE $F_c = 2,500$ psi
 - BASEMENT SLAB: SHALL BE $F_c = 2,500$ psi
 - PORCHES AND GARAGE SLAB: SHALL BE $F_c = 3,000$ psi
- WOOD MEMBER SPECIFICATIONS:**
 - LUMBER FOR STUDS, TRUSSES, BLOCKING, ETC. SHALL BE (SPF) OR (BYP) GRADE AS REQUIRED PER OBC CODE, CHAPTER 23, SECTION 2303.
 - SHEATHING:**
 - STRUCTURAL SHEATHING SHALL BE A MIN. OF 7/16" AND 48" IN WIDTH. EXTERIOR GRADE OSB OR PLYWOOD LOCATED AT EACH END AND AT LEAST EVERY 25' OF WALL LENGTH.
 - FLOOR SHEATHING SHALL BE MIN. 3/4" TONGUE AND GROOVE PLYWOOD.
 - ROOF SHEATHING SHALL BE MIN. 7/16" EXTERIOR GRADE OSB OR PLYWOOD.
- PRE-CAST CONCRETE LINTELS** - THE DESIGN FOR LINTELS SHALL BE IN ACCORDANCE WITH THE MASONRY DESIGN PROVISIONS OF EITHER SECTION 2107 OR 2108. MINIMUM LENGTH OF END SUPPORT SHALL BE 4 INCHES (102 MM). SEE CHAPTER 21, SECTION 2104.1.5.

- TRUSS DESIGN:**

TRUSS CONSTRUCTION DOCUMENTS SHALL BE PREPARED BY AN OHIO REGISTERED PROFESSIONAL ENGINEER AND SEALED AND SHALL BE PROVIDED TO THE BUILDING OFFICIAL AND APPROVED PRIOR TO INSTALLATION. METAL PLATE CONNECTED WOOD TRUSSES SHALL BE MANUFACTURED AS REQUIRED BY TPI 1. EACH MANUFACTURER OF TRUSSES USING METAL PLATE CONNECTORS SHALL RETAIN AN APPROVED AGENCY TO MAKE UNSCHEDULED INSPECTIONS OF TRUSS MANUFACTURING AND DELIVERY OPERATIONS. THE INSPECTION SHALL COVER ALL PHASES OF TRUSS OPERATIONS, INCLUDING LUMBER STORAGE, HANDLING, CUTTING FIXTURES, PRESSES OR ROLLERS, MANUFACTURING, BUNDLING, AND BANDING. SEE OBC CHAPTER 23, SECTION 2303.4 AND 2303.4.1 (TRUSS DESIGN DRAWINGS). THESE CONSTRUCTION DOCUMENTS SHALL INCLUDE, AT A MINIMUM, THE INFORMATION SPECIFIED IN THIS SECTION. TRUSS SHOP DRAWINGS SHALL BE PROVIDED WITH THE SHIPMENT OF TRUSSES DELIVERED TO THE JOB SITE. SUBMIT FOR APPROVAL THREE (3) SETS. DRAWINGS SHALL INCLUDE STRESSES IN ALL MEMBERS, CONNECTION DETAILS, AND SIZE OF ALL MEMBERS. USE SIMPSON ANCHOR PLATE BETWEEN TOP PLATE AND TRUSS TO PREVENT UPLIFT, NET 500 LBS.

WOOD AND CONCRETE HEADER SCHEDULE

UNLESS OTHERWISE SPECIFICALLY INDICATED ON THE DRAWINGS, PROVIDE FOLLOWING HEADERS/LINTELS FOR THE WALL OPENINGS.

OPENING	* WOOD MEMBERS	WD BEARING	** CONC BEARING
0'-3"	2-2x6 WITH 1/2" PLYWOOD	1.5" E.S.	4" E.S.
3'-5"	2-2x8 WITH 1/2" PLYWOOD	1.5" E.S.	4" E.S.
5'-6"	2-2x10 WITH 1/2" PLYWOOD	1.5" E.S.	4" E.S.
6'-8"	2-2x12 WITH 1/2" PLYWOOD	1.5" E.S.	4" E.S.

* FOR 2x6 WALLS, PROVIDE ADDITIONAL MEMBER OF SAME SIZE AND ADDITIONAL 1/2" PLYWOOD
 ** FOR POURED CONCRETE WALLS OR BLOCK, STEEL LINTEL TO RUN 4" PAST OPENING ON EITHER SIDE.

OBC DATA

USE GROUP: "B"
 TOTAL AREA: 690 SQ.FT.
 MAXIMUM OCCUPANCY: 6

INDEX OF SHEETS

C.1	COVER SHEET, DESIGN LOADS, GEN. INFO
A.1	EXTERIOR ELEVATIONS
A.2	FLOOR PLAN, PLUMBING ISO
E.1	ELECTRICAL LAYOUT

SITE PLAN
 SCALE: NONE

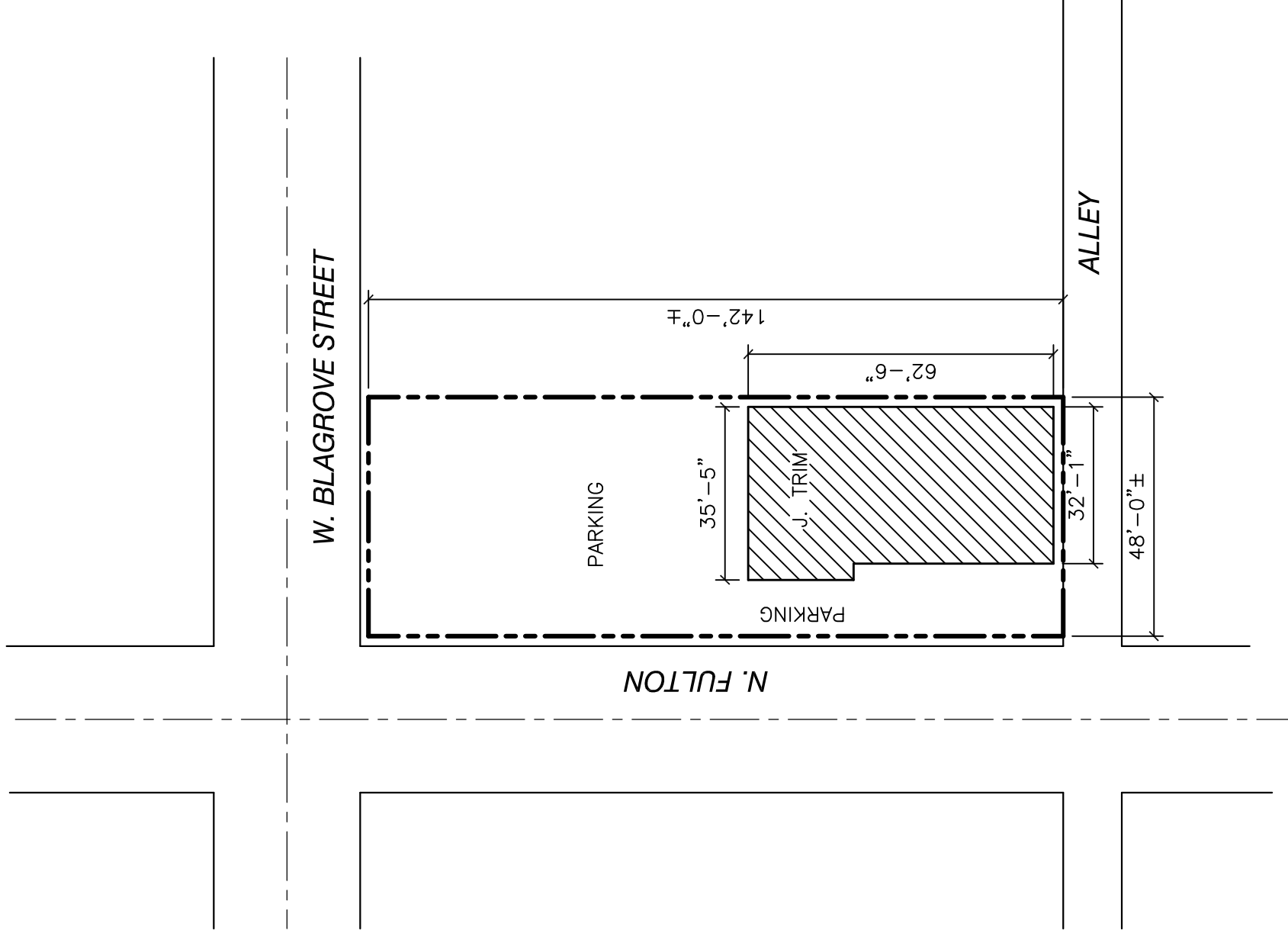

A NEW SALON/BARBER SHOP FOR J. TRIM

16 NORTH FULTON STREET
 RICHWOOD, OHIO 43344
 UNION CO.
 OWNER: JESSICA (JESS) WASSERBECK

NO.	CORR LTR DATE	REVISED ISSUE DATE

DESIGN BY PROFESSIONAL:
PIZZINO ENGINEERING & CONSULTING, LLC.
 WILLIAM J. PIZZINO, P.E.
 9495 SR 161
 PLAIN CITY, OHIO 43064

CONCEPT BUILDINGS, INC.
 MARYSVILLE, OHIO
 (937) 644-0605

THIS SHEET:
 COVER SHEET
 DATA INFO

PROJECT: RENOVATION
 SHEET: I OF 4
 DATE: 12-16-08
 DRAWN BY: P.R.M.
 SCALE: AS NOTED
C.1